

electric ball valve

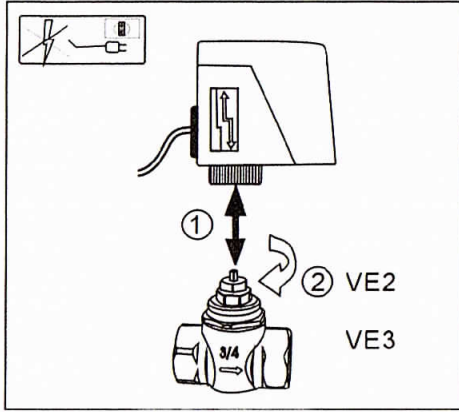

Actuator and valve installation

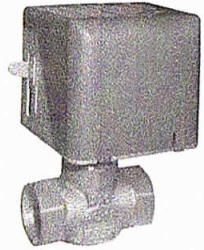
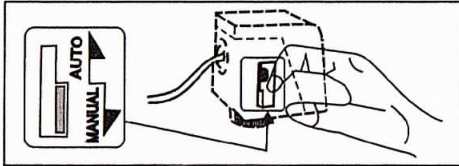

Automatic / manual selection

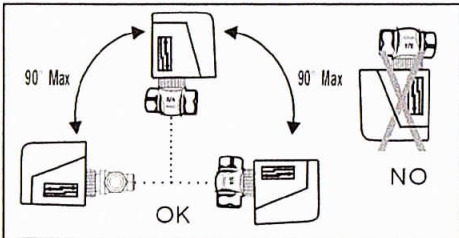

Installation site

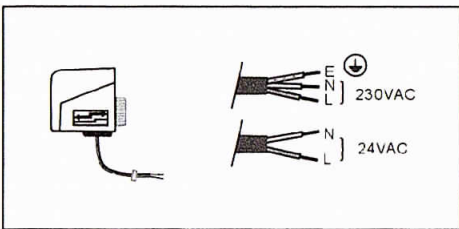

Wiring method

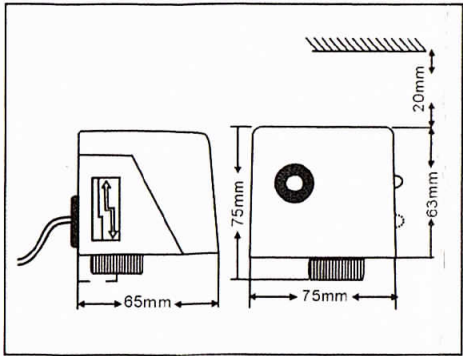

Appearance size

Levels of protection	IP40	
Control method	Two open / close	
Motor category	Hysteresis synchronous motor	
Power dissipation	6W	
Ambient temperature	work : 2~60℃ , No condensation	
	memory: -2~65℃ , No condensation	
SEV2023	230V	± 10% , 50/60Hz
SEV2024	24V	

Size of product

READ THIS INSTRUCTION SHEET CAREFULLY BEFORE INSTALLING AND SAVE FOR FUTURE USE

WARNING

The actuators are not equipped with a power supply switch. Therefore an additional switch to isolate the devices should be included in the power supply wiring to it. Switch off power supply when installing or servicing to prevent damage or electrical shock.

Note: These actuators are intended to control equipment under normal operating conditions. Where failure or malfunction of the actuator could lead to an abnormal operating condition that could cause personal injury or damage to the equipment or other property, other devices (limit or safety controls) or systems (alarm or supervisory systems) intended to warn of or protect against failure or malfunction of the actuator must be incorporated into and maintained as part of the control system.

Wiring

Mark sure that the line power supply is in accordance with the power supply specified on the device. all wiring should conform to local codes and must be carried out by authorized personnel only. When using multi-stranded wire apply a cable ferrule to the cable end.

Check out procedure

Before leaving the installation observe at least three complete operating cycles to be sure that all components are functioning correctly. If the device is not working properly and the mounting and all wiring is incorrect, the device should be replaced. please contact your nearest supplier.

Two normally closed valve and valve installation such as Figure 1, as shown in figure 2. In high-rise buildings, should use the pressure relief valve in the bottom branch. Install the valve, should pay attention to the body pointing arrow, if with auxiliary switch, the wiring diagram as shown in figure 4.

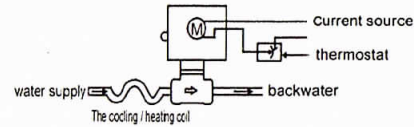
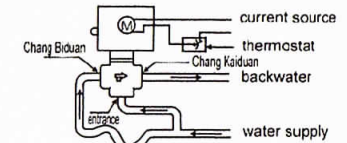
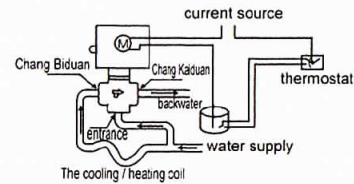

Figure one or two valves



The cooling / heating coil

Figure two three-way valve



The three-way valve figure three with box transfer switch

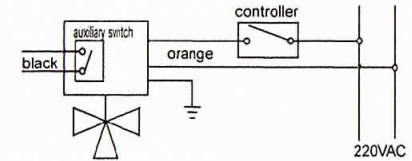

Figure four auxiliary switch wiring diagram